

PLAN OF PROPOSED BARE LAND
STRATA OF LOT C, DISTRICT LOT 79,
RUPERT DISTRICT, PLAN VIP71975.

B.C.G.S. 92L 056

SCALE 1:1000

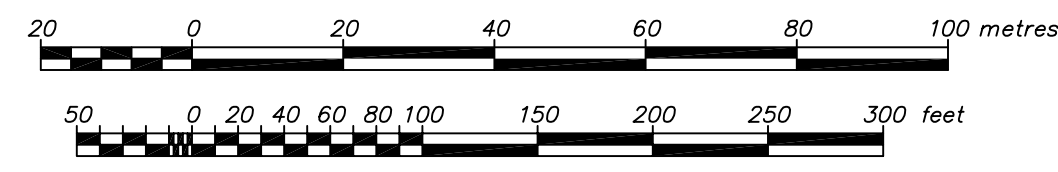

LEGEND:

--- denotes Phase Boundary

1.0 sq m = 10.765 sq ft

This plan lies within the Regional District of
Mount Waddington

Access is by Water Only

JOHNSTONE STRAIT

ELLA
POINT

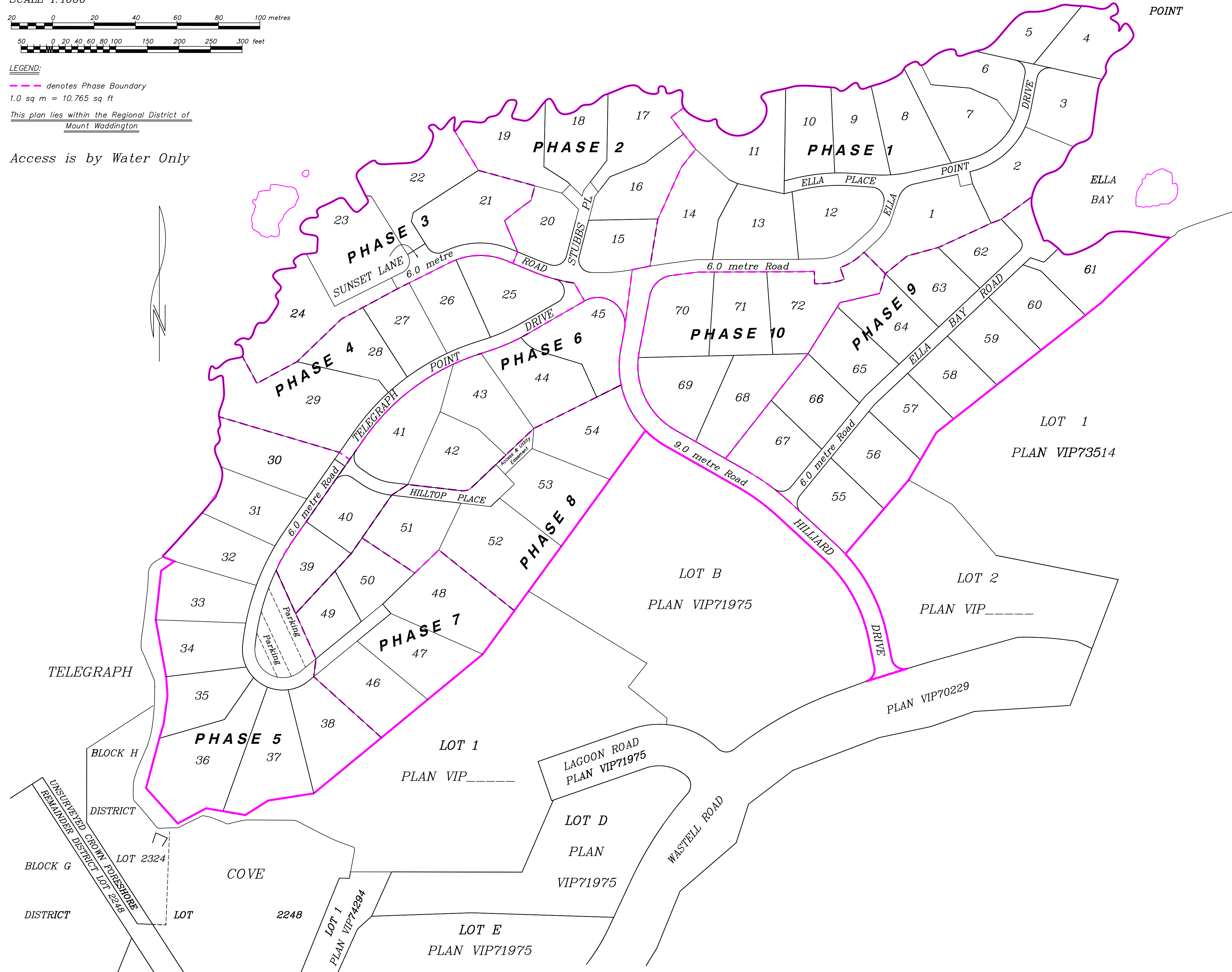

STRATA LOT	PHASE	AREA (m ²)	AREA (ft ²)	CIVIC ADDRESS
1	1	1480	15932	1515 Ella Point Drive
2	1	1100	11842	1505 Ella Point Drive
3	1	986	10614	1495 Ella Point Drive
4	1	969	10431	1485 Ella Point Drive
5	1	681	7331	1490 Ella Point Drive
6	1	829	8924	1500 Ella Point Drive
7	1	1290	13887	1510 Ella Point Drive
8	1	1100	11842	1520 Ella Point Drive
9	1	970	10442	3040 Ella Place
10	1	999	10754	3050 Ella Place
11	1	1410	15179	3060 Ella Place
12	1	1240	13349	1530 Ella Point Drive
13	1	1220	13133	1540 Ella Point Drive
14	1	1350	14533	1550 Ella Point Drive
ROAD	1	4210	45321	
15	2	836	9000	3085 Stubbs Place
16	2	1050	11303	3075 Stubbs Place
17	2	1240	13349	3065 Stubbs Place
18	2	1060	11411	3070 Stubbs Place
19	2	1270	13672	3080 Stubbs Place
20	2	893	9613	3090 Stubbs Place
ROAD	2	879	9462	
21	3	1472	15846	1600 Sunset Lane
22	3	1500	16148	1610 Sunset Lane
23	3	1670	17978	1620 Sunset Lane
24	3	1700	18301	1630 Sunset Lane
ROAD	3	462	4973	
25	4	1191	12821	
26	4	940	10119	
27	4	926	9968	
28	4	995	10711	
29	4	2347	25265	
ROAD	4	910	9796	
30	5	1303	14027	
31	5	995	10711	
32	5	1020	10980	
33	5	1075	11572	
34	5	980	10550	
35	5	955	10281	
36	5	1918	20647	
37	5	1485	15986	
38	5	1258	13542	
ROAD	5	1752	18860	
39	6	795	8558	
40	6	815	8773	
41	6	1299	13984	
42	6	1060	11411	
43	6	1140	12272	
44	6	1293	13919	
45	6	1283	13811	
ROAD	6	191	2056	
46	7	1217	13101	
47	7	1203	12950	
48	7	1627	17515	
49	7	687	7396	
50	7	782	8418	
ROAD	7	269	2896	
51	8	1062	11432	
52	8	1777	19129	
53	8	1343	14457	
54	8	1389	14953	
ROAD	8	457	4920	
Access & Utility Easement	8	141	1518	
55	9	1010	10873	
56	9	1040	11196	
57	9	816	8784	
58	9	854	9193	
59	9	942	10141	
60	9	984	10593	
61	9	1280	13779	
62	9	698	7514	
63	9	917	9872	
64	9	965	10388	
65	9	987	10625	
66	9	979	10539	
67	9	1060	11411	
ROAD	9	1360	14640	
68	10	1270	13672	
69	10	1230	13241	
70	10	1240	13349	
71	10	1130	12164	
72	10	1440	15502	